

NORTH AMERICAN SEAL

& Packing Company

530 Van Ness Ave. Fresno, CA 93721
 (559) 264-7325 -- Fax: (559) 268-5207

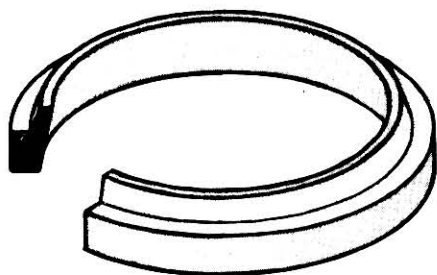

WIPERS

TYPE W HD
 STYLE 52 (INCH SIZES)

CHARACTERISTICS

North American Seal's Wiper / Scraper is designed to remove the more aggressive contaminants encountered by heavy outdoor machinery such as earth moving equipment.

Its solid cross section profile and heavy duty lip with good interference on the rod, are its main features.

Combining these characteristics with the proven abrasion resistant qualities of liquid cast polyurethane, has resulted in a tough durable wiper able to handle the most severe service conditions.

NAS Style 52 Wipers are available in a full range of sizes. It is installed by springing into a simple groove.

MATERIAL

- TYPE: Unithane 395 A, Liquid Cast Polyurethane
- HARDNESS: Durometer 95 A
- FLUID COMPATIBILITY: See Material Specifications Technical Bulletin

NOTE:

For Medium Duty, AN Type Wiper applications, refer to Technical Bulletin WAN-89

ORDERING INFORMATION

Please review current price list for tooling availability before ordering. A nominal tooling charge may be required for some non-tooled sizes.

Add Prefix W HD to signify a Heavy Duty Wiper.

e.g. A Heavy Duty Wiper, 2 1/2 I.D. is Part No: W HD 0250

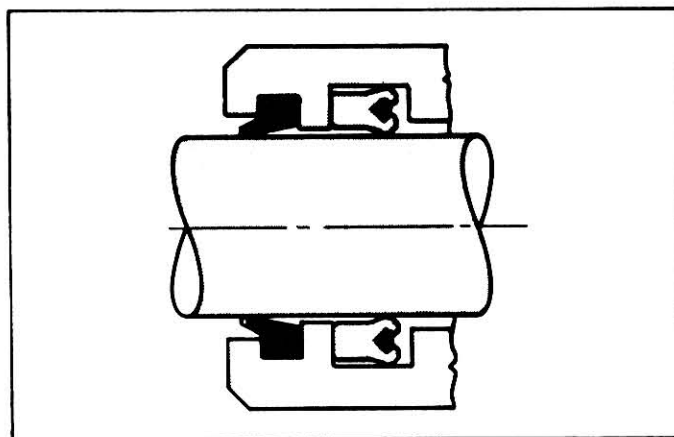

WIPERS

SEAL DIMENSIONS

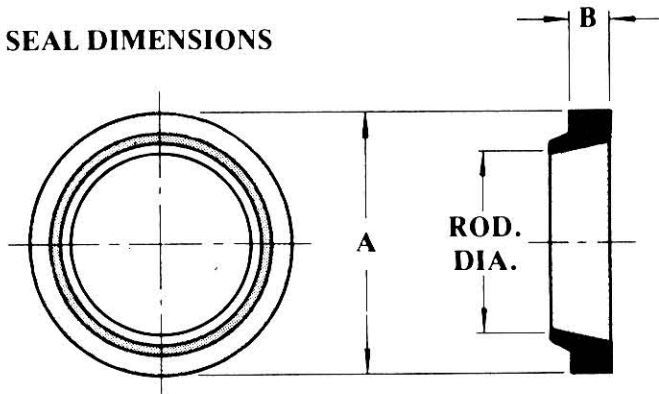

GROOVE DIMENSIONS

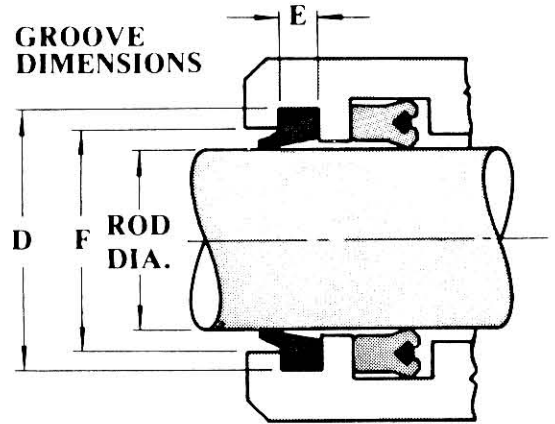

PART NO.	ROD DIA.	SEAL DIMENSIONS		GROOVE DIMENSIONS		
		"A" Outer DIA.	"B" Base Thick- ness	"D" +.006 -.000	"E" +.004 -.000	"F" +.010 -.000
-0437	7/16	11/16	1/8	0.685	.124	0.598
-0500	1/2	3/4	1/8	0.747	.124	0.660
-0562	9/16	13/16	1/8	0.810	.124	0.725
-0625	5/8	7/8	1/8	0.872	.124	0.785
-0687	11/16	15/16	1/8	0.935	.124	0.850
-0750	3/4	1-1/8	3/16	1.122	.187	0.995
-0812	13/16	1-3/16	3/16	1.185	.187	1.060
-0875	7/8	1-1/4	3/16	1.247	.187	1.120
-0937	15/16	1-5/16	3/16	1.310	.187	1.185
-1000	1	1-3/8	3/16	1.372	.187	1.245
-1062	1-1/16	1-7/16	3/16	1.435	.187	1.310
-1125	1-1/8	1-1/2	3/16	1.497	.187	1.370
-1187	1-3/16	1-9/16	3/16	1.560	.187	1.435
-1250	1-1/4	1-5/8	3/16	1.622	.187	1.495
-1312	1-5/16	1-11/16	3/16	1.685	.187	1.560
-1375	1-3/8	1-3/4	3/16	1.747	.187	1.620
-1437	1-7/16	1-13/16	3/16	1.810	.187	1.685
-1500	1-1/2	1-7/8	3/16	1.872	.187	1.745
-1562	1-9/16	1-15/16	3/16	1.935	.187	1.810
-1625	1-5/8	2	3/16	1.997	.187	1.870
-1687	1-11/16	2-1/16	3/16	2.060	.187	1.935
-1750	1-3/4	2-1/8	3/16	2.122	.187	1.995
-1812	1-13/16	2-3/16	3/16	2.185	.187	2.060
-1875	1-7/8	2-1/4	3/16	2.247	.187	2.120
-1937	1-15/16	2-5/16	3/16	2.310	.187	2.185
-2000	2	2-1/2	1/4	2.497	.249	2.327
-2062	2-1/16	2-9/16	1/4	2.560	.249	2.390
-2125	2-1/8	2-5/8	1/4	2.622	.249	2.452
-2187	2-3/16	2-11/16	1/4	2.685	.249	2.515
-2250	2-1/4	2-3/4	1/4	2.747	.249	2.577
-2312	2-5/16	2-13/16	1/4	2.810	.249	2.640
-3275	2-3/8	2-7/8	1/4	2.872	.249	2.702
-2437	2-7/16	2-15/16	1/4	2.935	.249	2.765
-2500	2-1/2	3	1/4	2.997	.249	2.827
-2562	2-9/16	3-1/16	1/4	3.060	.249	2.890
-2625	2-5/8	3-1/8	1/4	3.122	.249	2.952
-2687	2-11/16	3-3/16	1/4	3.185	.249	3.015
-2750	2-3/4	3-1/4	1/4	3.247	.249	3.077
-2812	2-13/16	3-5/16	1/4	3.310	.249	3.140
-2875	2-7/8	3-3/8	1/4	3.372	.249	3.202

PART NO.	ROD DIA.	SEAL DIMENSIONS		GROOVE DIMENSIONS		
		"A" Outer DIA.	"B" Base Thick- ness	"D" +.006 -.000	"E" +.004 -.000	"F" +.010 -.000
-2937	2-15/16	3-7/16	1/4	3.435	.249	3.265
-3000	3	3-1/2	1/4	3.497	.249	3.327
-3125	3-1/8	3-5/8	1/4	3.622	.249	3.452
-3250	3-1/4	3-3/4	1/4	3.747	.249	3.577
-3375	3-3/8	3-7/8	1/4	3.872	.249	3.702
-3500	3-1/2	4	1/4	3.997	.249	3.827
-3625	3-5/8	4-1/8	1/4	4.122	.249	3.952
-3750	3-3/4	4-1/4	1/4	4.247	.249	4.077
-3875	3-7/8	4-3/8	1/4	4.372	.249	4.202
-4000	4	4-1/2	1/4	4.497	.249	4.327
-4125	4-1/8	4-5/8	1/4	4.622	.249	4.452
-4250	4-1/4	4-3/4	1/4	4.747	.249	4.577
-4375	4-3/8	4-7/8	1/4	4.872	.249	4.702
-4500	4-1/2	5-1/4	3/8	5.247	.374	4.993
-4625	4-5/8	5-3/8	3/8	5.372	.374	5.118
-4750	4-3/4	5-1/2	3/8	5.497	.374	5.243
-4875	4-7/8	5-5/8	3/8	5.622	.374	5.368
-5000	5	5-3/4	3/8	5.747	.374	5.493
-5125	5-1/8	5-7/8	3/8	5.872	.374	5.618
-5250	5-1/4	6	3/8	5.997	.374	5.743
-5375	5-3/8	6-1/8	3/8	6.122	.374	5.868
-5500	5-1/2	6-1/4	3/8	6.247	.374	5.993
-5625	5-5/8	6-3/8	3/8	6.372	.374	6.118
-5750	5-3/4	6-1/2	3/8	6.497	.374	6.243
-5875	5-7/8	6-5/8	3/8	6.622	.374	6.368
-6000	6	6-3/4	3/8	6.747	.374	6.493
-6250	6-1/4	7	3/8	6.997	.374	6.743
-6500	6-1/2	7-1/4	3/8	7.247	.374	6.993
-6750	6-3/4	7-1/2	3/8	7.497	.374	7.243
-7000	7	7-3/4	3/8	7.747	.374	7.493
-7250	7-1/4	8	3/8	7.997	.374	7.743
-7500	7-1/2	8-1/4	3/8	8.247	.374	7.993
-7750	7-3/4	8-1/2	3/8	8.497	.374	8.243
-8000	8	8-3/4	3/8	8.747	.374	8.493
-8250	8-1/4	9	3/8	8.997	.374	8.743
-8500	8-1/2	9-1/4	3/8	9.247	.374	8.993
-8750	8-3/4	9-1/2	3/8	9.497	.374	9.243
-9000	9	9-3/4	3/8	9.747	.374	9.493
-9250	9-1/4	10	3/8	9.997	.374	9.743